

**HVF
Series**



High Volume Low Velocity Fan





HVF Series

High Volume Low Velocity Fan

Introduction

GTG HVF Series is our **BLDC HVLS** fan which is specially developed to provide high air volume at low velocity for **commercial and industrial application** for spacious area with high ceiling space. The blades are designed using advance aerodynamic principles hence able to simulate gentle natural breeze of 1-3 m/s for smooth air movement in wide space to achieve effective ventilation and total human comfort.

Range

HVF 20, HVF 30, HVF 37, HVF 45, HVF 55, HVF 60 & HVF 73

Features

- BLDC motor for energy efficient operation at zero maintenance and longer lifespan as less moving parts.
- Average 50% reduction in power consumption over standard AC motors.
- Low operation noise as not using gear reduction to control speed
- Airfoil shape powder coated aluminium alloy extruded blades can produce high volume of air velocity with less energy for optimum performance.
- Interlocking safety system reinforced the connection between the fan unit and its airfoils blades for better security even in extreme conditions.
- Industrial-grade performance and circuit protection providing advanced controls while protecting the direct drive motors in harsh industrial environments.

Specification

Motor

Type: High Efficiency DC motor

Blades

Material : Aluminium alloy with powder coating finishing

Casing & Bracket

Material : Galvanized steel

Control Box

Material : Galvanized steel with powder coating finishing

Beaufort wind scale

| Beaufort No | Description | Recommended Velocity (FPM) | Recommended Velocity (m/s) |
|-------------|-----------------|----------------------------|----------------------------|
| 0 | Calm | 30 | 0.15 |
| 1 | Light Air | 177 | 0.90 |
| 2 | Light Breeze | 482 | 2.45 |
| 3 | Gentle Breeze | 881 | 4.47 |
| 4 | Moderate Breeze | 1,319 | 6.70 |
| 5 | Fresh Breeze | 1,841 | 9.35 |

Control Box



Technical Specifications

| Model | HVF 20 | HVF 30 | HVF 37 | HVF 45 | HVF 55 | HVF 60 | HVF 73 |
|---|----------------|--------|--------|--------|--------|--------|--------|
| Diameter (mm) | 2000 | 3000 | 3700 | 4500 | 5500 | 6000 | 7300 |
| Airflow (CMH) | 156860 | 351180 | 480000 | 605300 | 706700 | 780000 | 860000 |
| Nos of Blades | 5 | 5 | 5 | 6 | 6 | 6 | 6 |
| Weight (kg) | 47.8 | 53.5 | 60 | 102 | 116 | 125.5 | 134.5 |
| Sound Level (dBA) @ 3m | 50 | 51 | 51 | 51.5 | 52 | 53 | 53 |
| Motor (kW) | 0.25 | 0.55 | 0.55 | 0.75 | 1.1 | 1.5 | 1.5 |
| RPM | 211 | 145 | 115 | 104 | 64 | 60 | 56 |
| Control | Variable Speed | | | | | | |
| Drive | Direct Drive | | | | | | |
| Control Box Dimension (mm) (W x H x D) | 250×330×160 | | | | | | |
| Volt / Phase / Hz | 230/1/50 | | | | | | |
| Full Load Current (A) | 1.2 | 2.4 | 2.8 | 3.5 | 5 | 6.5 | 9.5 |
| Recommended Wire Size (mm ²) | 2.5 | 2.5 | 2.5 | 2.5 | 2.5 | 2.5 | 2.5 |

Fan Placement & Clearance

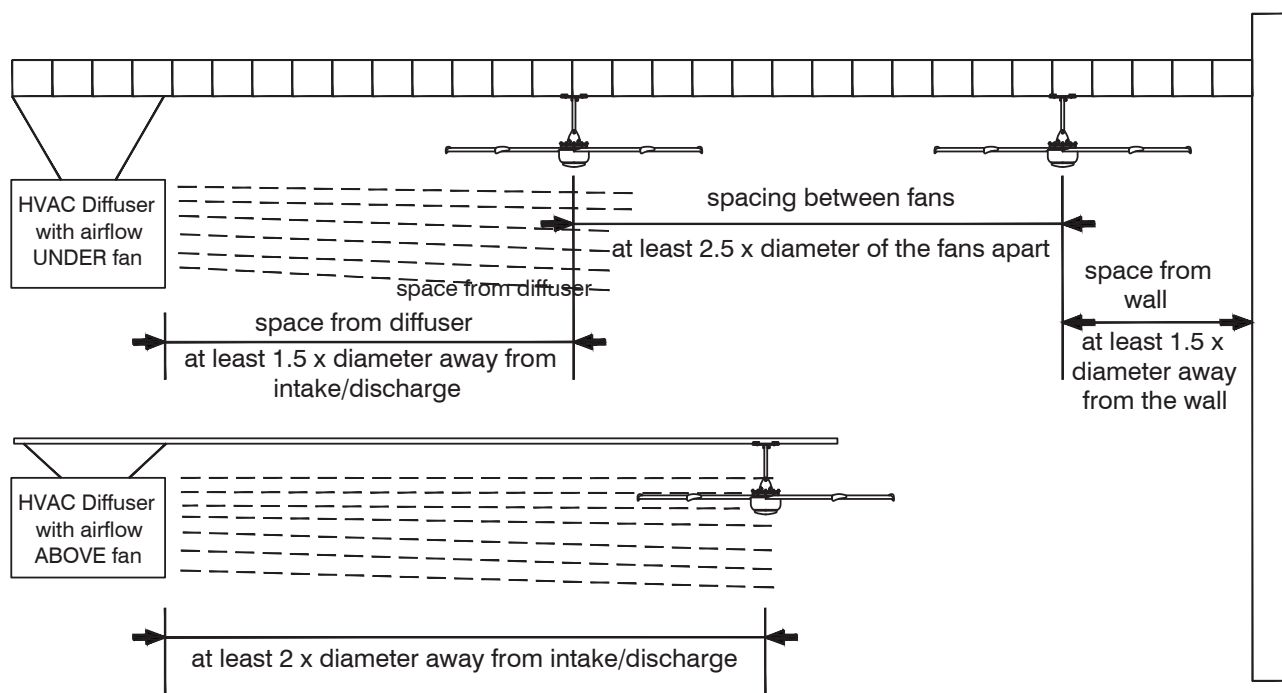

* The blades/airfoils to have a minimum of 2 ft (600 mm) of clearance from obstructions and the building structure.

Dimensions (mm)

Dimension ≤ 3700 mm

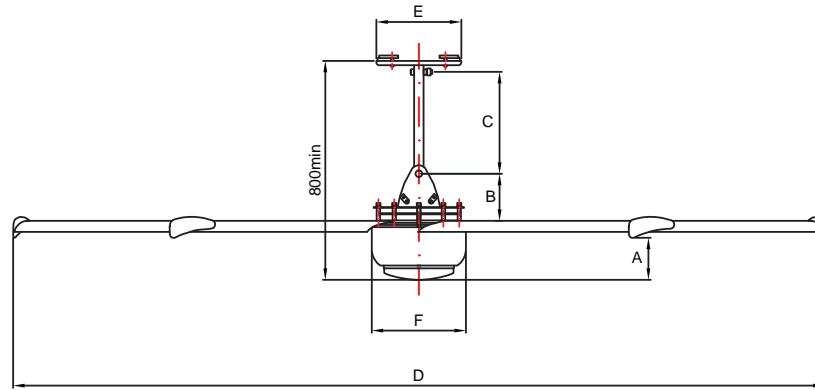

Dimension ≥ 4000 mm

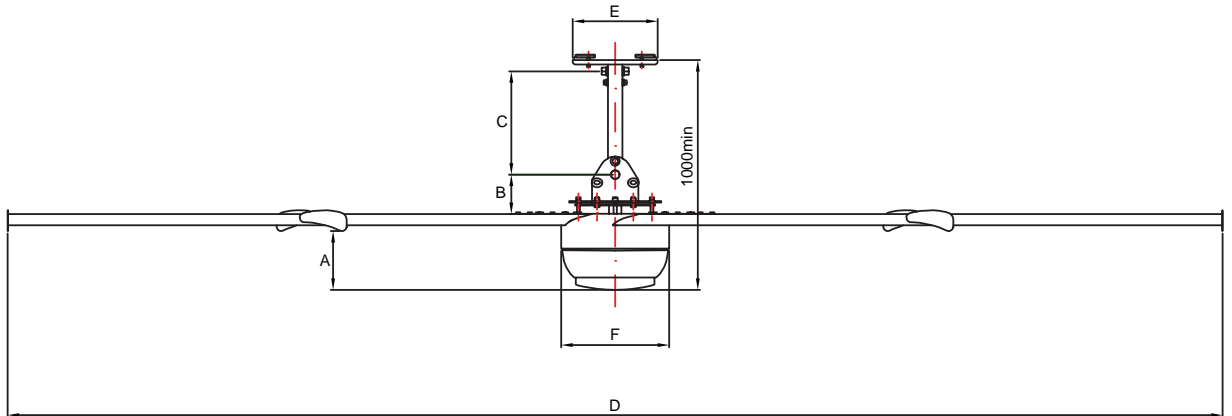

| Model | A | B | C | D | E | ØF | Max. Installation Height (M) |
|--------|-----|-----|------|------|-----|-----|------------------------------|
| HVF 20 | 200 | 193 | 300 | 2000 | 370 | 410 | 5 |
| HVF 30 | 200 | 193 | 600 | 3000 | 370 | 410 | 5.5 |
| HVF 37 | 200 | 193 | 900 | 3700 | 370 | 410 | 6 |
| HVF 45 | 300 | 172 | 900 | 4500 | 370 | 470 | 6.5 |
| HVF 55 | 300 | 172 | 1200 | 5500 | 370 | 470 | 7 |
| HVF 60 | 300 | 172 | 1200 | 6000 | 370 | 470 | 7.5 |
| HVF 73 | 300 | 172 | 1500 | 7300 | 370 | 470 | 8 |

GTG Industries Sdn Bhd

(912584-W)

No. 13, Jalan Astaka U8/88B,
 Seksyen U8, Bukit Jelutong,
 40150 Shah Alam, Selangor, Malaysia
 TEL +603-78590213/0216/0217 FAX +603-78590218
 EMAIL inquiry@gtg.com.my WEBSITE www.gtg.com.my



SCAN & VISIT OUR WEBSITE